

## INSTRUCTIONS FOR THE BirdSpa™

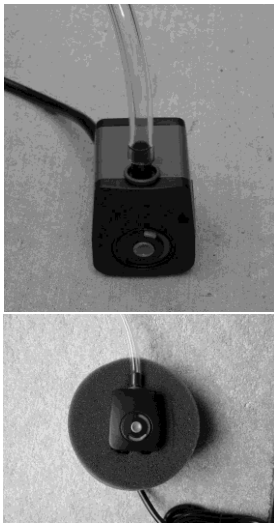

Step 1: Find flat, level ground preferably sheltered from the wind by some trees or tall shrubs and set the bowl of the bath on it. *(In hot climates please place the bath in shade to keep the water as cool as possible.)* Rinse it out with your hose several times to remove any dust or dirt from shipping.



Step 2: Take the pump out of the box, put the small hard plastic nozzle in the outlet and slip the vinyl tube on it. Slide the gray foam biofilter around the pump, **covering the intake slots**. For maximum water lift make sure the flow control is turned all the way up. Place the pump inside the bottom of the basin and run the electrical cord out through the PVC conduit.

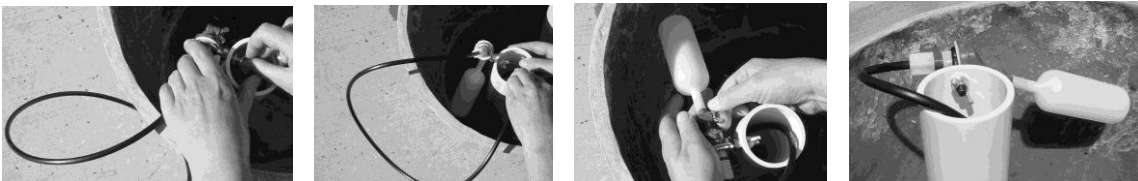

### Step 3:

- A) Find the mini-float valve and remove the wing nut and lock washer from the eyebolt it is attached to; slide the eyebolt through the hole in the PVC pipe, replace the lock washer and wing nut but do not tighten yet.
- B) Run the tubing through the top of the PVC, leaving a slight loop, and run it out the bottom. **Do not kink the tubing.**
- C) Loosen the wing nut on the mini-valve and straighten out the float; re-tighten the nut.
- D) Level the float valve and tighten it firmly.

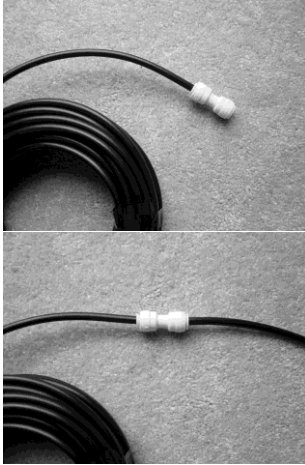

Step 4: Attach the supplied 50ft. length of tubing to the short piece of tubing extending from the basin using the white quick-connect. Simply press the end of the short piece of tubing leading from the float valve into the quick-connect. (This is a great feature: you can quickly disconnect the tubing when you need to mow the lawn, attach an optional garden irrigation system, etc. Just press the tube in, hold the end of the quick-connect and pull the tubing out.)



Step 5: Attach the Y-valve to your water spigot. Adjust the water flow until there is a **very gentle stream** of water coming out of the mini-valve in the bath. (*I've found it easiest to do by slightly turning on the faucet and then slightly opening the stopcock on the Y-valve.*) When satisfied with the flow of the water, quickly fill the bottom of the basin with your hose until it shuts off the valve. Add the floating square of bird bath cleaner to the water



Step 6: Center the bird bath top over the basin and fill it with water until it begins to flow down through the center. If the water drips or flows off the rim rather than through the center, either the bowl is not on a level surface or the top is not nestled in the bowl so that it is level. Shim the bottom basin (or top) until water flows down only the center hole

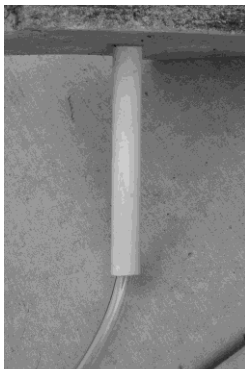

Step 7: Reach in the center of the bath and slide the vinyl tubing into the small rigid conduit of the decorative topper. Place the topper over the center hole and plug in the pump to either a grounded outdoor circuit or a UL approved outdoor extension cord and watch the water bubble up! **(It is highly recommended that you have ground fault interrupters (GFI) installed on all outdoor sockets or any socket where there is danger of water seepage).**



#### NOTES:

The BirdSpa™ can be decorated with river rock, aquarium gravel, etc. This adds extra interest for people and birds and can be changed to give a new look whenever it is desired. Just avoid anything sharp-edged or jagged.

It may take several days for birds to come to the bath as they are very vulnerable when they bathe and are usually quite cautious when approaching a new source of water. Once the birds become comfortable with the BirdSpa™, they will be devoted to this constantly full and bubbling source of fresh, clean water! Enjoy!

## BirdSpa™ MAINTENANCE TIPS

The BirdSpa™ is a very low maintenance birdbath but does require some attention. Here are several things you will need to do regularly (every few weeks, depending on conditions):

- 1) The pump comes with a gray foam biofilter that will keep the pump safe from large debris (grass clippings, seed casings, etc.) and allows the water to bubble freely for up to a month or more before the filter needs to be rinsed clean. When you notice the bubbling action has become sluggish, unplug the pump, take off the decorative topper and pull the pump up. Slip off the filter and give it a good rinsing with the hose and clean the pump by running water down the tubing (called "back flushing"). Slip the filter back on and put the pump back in the basin.
- 2) The biofilter provides an excellent habitat for nitrifying bacteria to colonize. Adding a two to three inch layer of **clean**, small volcanic landscape rock in the bottom of the basin adds more habitat for the bacteria and also captures debris.
- 3) A weekly supply of enzymes provided by CareFree Enzymes helps the nitrifying bacteria by breaking down the organic contaminants (i.e. bird droppings) into easily digestible nutrients. Adding more bacteria at least once a month also helps and additional squares of Bioverse Birdbath Cleaner can be purchased. A liquid brand can also be used e.g., Microbe-Lift; follow the manufacturer's recommendation on the amount to use for 7 gallons of water. You can also try a mild algacide called Fountec made by McGrayel Ind. When used properly (1 or

- 2 drops per gallon a week) it is both effective and safe. If you add decorative aquarium gravel or pebbles to the top bathing dish, rinsing of the gravel weekly or twice monthly is recommended to remove both tiny and large debris that the gravel removes from the water. The easy way to do this is to shut off the pump and slightly tip the top to run off the water while rinsing the gravel with your hose's nozzle set on shower. This will float out any debris caught between the pebbles.
- 4) Even though the bath has a good colony of bacteria that competes successfully with algae for nutrients, there will still be a small amount of algae will cling to the rim of the bath, or in the decorative stones that you use, or to the edges of the decorative topper. Simply take a gentle scrubber like you would use for non-stick cookware and lightly brush these "desperados" away.
  - 5) You can bury the 1/4" polyethylene tubing if you'd like but this is not recommended if you have moles in your area as they like to munch on the tubing. You can also crop the tubing to whatever length desired.

In the winter you can place a 250Watt or greater heater in the top or bottom to keep the bath re-circulating; **however, we do not warranty the bath against damage incurred by freezing.** To avoid all possibility of damage please put the bath inside before the first hard freeze. If storing outside, drain the bath and turn the bowl and top over so snow and rain cannot collect inside; then cover the pieces with a plastic tarp. **You can leave the 1/4" tubing outside; just make sure it is drained.**