



ALLIED PRECISION INDUSTRIES, INC.  
705 E. North Street  
Elburn, IL 60119

## Instructions for Heated Poultry Fountain Model 33 Setup and Operation

### Specifications

Capacity: 3 gallons (11.3 liters)  
Electrical: 100 watts, 120 VAC, 60 Hz

### Features

- The Model 33 Poultry Fountain contains two separate, individually-controlled heating circuits to ensure efficient, ice-free operation. The unit is divided into two zones—the drinking trough and the reservoir—so that only the zone actually needing heat is activated.
- A funnel on the bottom of the basin makes the reservoir easy to fill.
- When not in use, the power cord wraps around the funnel, out-of-sight for storage.
- The wide basin provides easy access to the drinking water.
- The patented LOCKNDRY™ plug securely mates with LOCKNDRY extension cords for worry-free operation.

### CAUTION

1. Have a qualified electrician install a properly grounded receptacle outlet adjacent to the location where the unit will be used. If used outdoors, make sure that the outlet is acceptable for outdoor use and protected from snow and rain.
2. Route the power supply cord so it is protected from damage.
3. Inspect the cord before using.
4. Unplug the unit when filling with water.
5. Unplug the cord and wrap it under the basin during the summer.
6. Connect to properly grounded outlets only.
7. **Connect only to a circuit that is protected by a Ground Fault Circuit Interrupter (GFCI).** This is a sensitive device that cuts off the electricity if there is any leakage to ground. This device may be obtained from any electrician or hardware store.

### IMPORTANT

This product is approved for use **only** with the **LOCKNDRY™** extension cord. It is not approved for use with any other extension cords. The plug on this product is specially designed to mate with the LOCKNDRY cord to form a water resistant seal. Mating receptacles can be identified by the red locking nut on each cord. The back of this sheet shows how the plug mates with the LOCKNDRY cord.

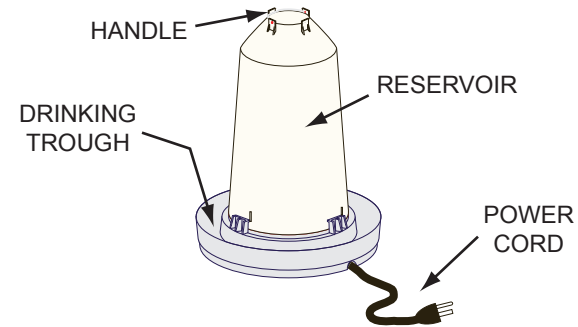

### Operation

1. Attach the reservoir to the basin by placing it within the raised ring and rotating it clockwise until it locks in place.
2. Unwrap the power cord and route it through the groove on the underside of the basin.
3. Plug the cord into a GFCI protected outlet.
4. To fill the reservoir, unplug the power cord and turn the unit upside down. Unscrew the plug and fill the reservoir with water. Screw in the plug until snug. Carefully, turn the unit right side up and place where desired. Plug in the power cord.

### Warranty

This product is warranted for a period of 12 months from the date of purchase. If you believe it is defective and still within the warranty period, return it to the place of purchase for inspection and possible replacement. The warranty is voided if the cord has been modified in any way or there is evidence of general abuse such as animals chewing on the cord. This warranty does not cover incidental or consequential damage resulting from either a defect in parts, materials, or operation failure. Some states do not allow the exclusion or limitation of the above damages so the above limitation may not apply to you. No agent, employee, or representative of Allied Precision has any authority to bind Allied Precision to any affirmation, representation or warranty directed towards any products bearing the Allied Precision name, except as stated herein. This warranty gives you specific legal rights—you may also have other rights which vary from state to state.

# Instructions for the LOCKNDRY™ cordset

---

## FEATURES

- Plugs into any normal 3-prong outlet
- Mates with LOCKNDRY plugs to form a water-resistant seal
- Keeps connection from separating during use
- Second, locking nut for secure connections

## INSTRUCTIONS

(1) Insert the plug into the receptacle just as you would a normal extension cord making sure the plug is fully inserted.

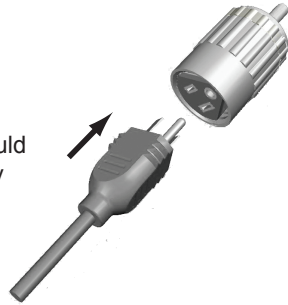

(2) Slide the large nut forward to engage the threads on the plug.

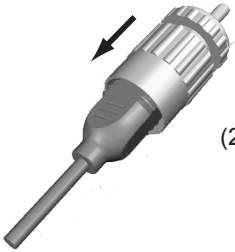

(3) Rotate the nut to tighten the plug against the receptacle.

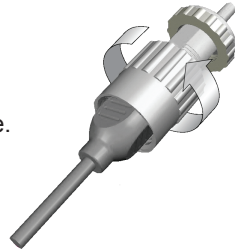

(4) Slide the second, thinner, red nut forward to engage the threads.

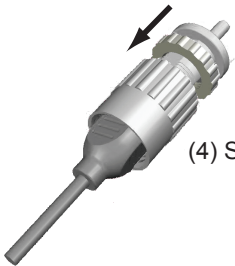

(5) Rotate the red nut snugly against the larger nut.

